

Power Nut Splitter



Features :

- Safe : No sparks. No flames. No risk to volatile surroundings. No hammers or impact needed. No flying fragments.
- Fast : Cuts a 3" nut in 20 to 30 seconds vs. approx. 20 minutes with a hammer & chisel or torch.
- Easy Set up : You can be up and away in less than 5 minutes.
- No Damage to bolt or stud threads by calibrating the chisel so that only the nut is cut.
- Versatile : Power splitters cut the hardest nuts. The range of models offered and the range of each model compares very favorably vs. the competition.

Power Splitter

Model - AS-105
to
Model - AS-506

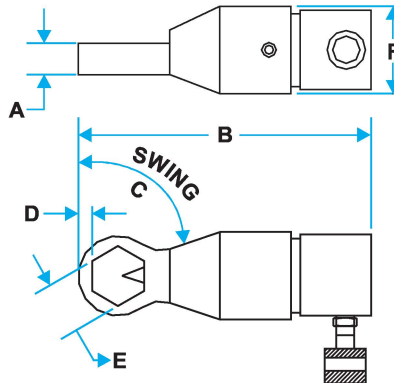

Power Splitter

Model No.	Stud Diameter		Nut A/F 		A	B	C	D	E	F	Weight	
	mm	inch	mm	inch							mm	mm
AS-105	11 - 22	7/16 - 7/8	16 - 36	5/8 - 1.7/16	38	271	60°	10	38	105	9.82	21.60
AS-200	22 - 32	7/8 - 1.1/4	36 - 51	1.7/16 - 2	38	287	45°	13	54	108	10.42	22.90
AS-204	32 - 38	1.1/4 - 1.1/2	46 - 60	1.13/16 - 2.3/8	57	385	30°	14	64	164	32.50	71.50
AS-210	35 - 45	1.3/8 - 1.3/4	57 - 70	2.1/4 - 2.3/4	57	398	30°	18	73	164	32.86	72.30
AS-308	45 - 57	1.3/4 - 2.1/4	70 - 89	2.3/4 - 3.1/2	78	460	30°	19	99	214	72.12	158.66
AS-314	50 - 64	2 - 2.1/2	79 - 98	3.1/8 - 3.7/8	80	488	30°	22	108	214	74.52	163.94
AS-404	64 - 70	2.1/2 - 2.3/4	95 - 108	3.3/4 - 4.1/4	95	579	60°	29	118	251	114.18	251.20
AS-500	76 - 83	3 - 3.1/4	114 - 127	4.1/2 - 5	105	590	60°	29	137	251	116.62	256.56
AS-506	83 - 89	3.1/4 - 3.1/2	124 - 136	4.7/8 - 5.3/8	105	598	60°	29	149	251	119.50	262.90